

# **MTC 160 A, MTC 160 B**

## **Mobile interpreter cabin**

**(ISO 4043.1998 E compliant)**

### **1. Technical parameters**

Measurements:

Installed:	160 x 160 x 205 cm
Packed:	82 x 205 x 38 cm
Weight:	~ 100 kg

SPL isolation (250-4000 Hz): 12 dB

Material: pine-tree

### **2. Description and assembling**

According to the illustration below the interpreter cabin consists of the following six elements:

- 4 walls with hinges:
  - 2 wall-units with 2 windows
  - 1 wall-unit with 1 door
  - 1 general wall-unit
- 1 roof-unit
- 1 table-unit

Due to its modularity it is possible to use the wall-unit with side door or back door. Assembling requires 2 people but an experienced person could be sufficient too. There are no separated binders packed they are built in the modules.

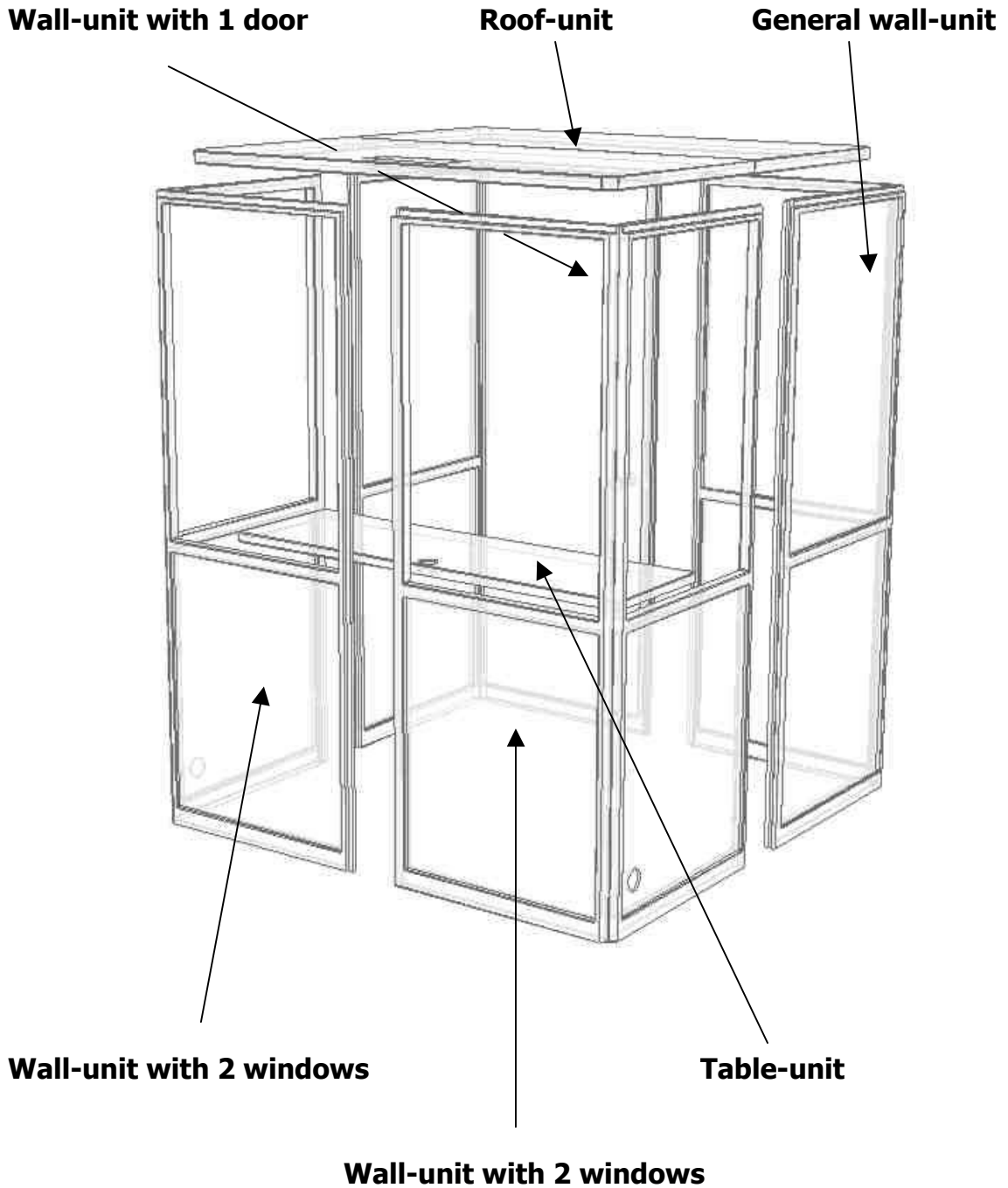

Choosing the most optimal location of the cabin the followings should be considered:

- The surface of the settlement place has to be horizontal, flat and smooth
- 40-50 cm free space is required around the cabin for assembling
- In the final position the free space should be 80-100 cm on the door side
- Cabin is recommended to be assembled in its final location to avoid further moving
- Cabin is recommended to be placed where the interpreters can see the performers and they can enter or leave the cabin without disturbing the event.

After considering the above follow the assembling instructions below. According to the illustration below the side of the wall-unit with hinges will form the vertical edges of the cabin.

**1. First step: rough settling of the 4 wall-units.**

- The units should be square open and placed according to the planned window and door locations.

**2. Second step: fitting 2 neighbouring units in.**

- Closing the vertical walls with hinges to each other, fastening them together and fixing the walls by turning the upper and lower butterfly lock. The wall-unit with the window is recommended to be the first and the wall-unit with the door is the last.

**3. Third step: setting the table.**

- The table gives the final stiffness of the cabin. Slip the binders built in the table and the walls into each other.

**4. Fourth step: placing the roof.**

- The roof is recommended to be placed while it is folded and unfold it above if there is enough space. Binders should jump into their right positions.

**5. Fifth step: cabling.**

- Cabling can happen through the slots of the wall-units and table.

### 3. Binding elements

Fitting the wall-units to each other is one of the most important parts of the assembling. Butterfly locks are used for this purpose at MTC 160 cabin family. The vertical edges of two wall-units meet at the centre line of the side of the cabin. Butterfly locks situated on the upper and the lower sides of the wall-units fix them.

Using the butterfly lock.

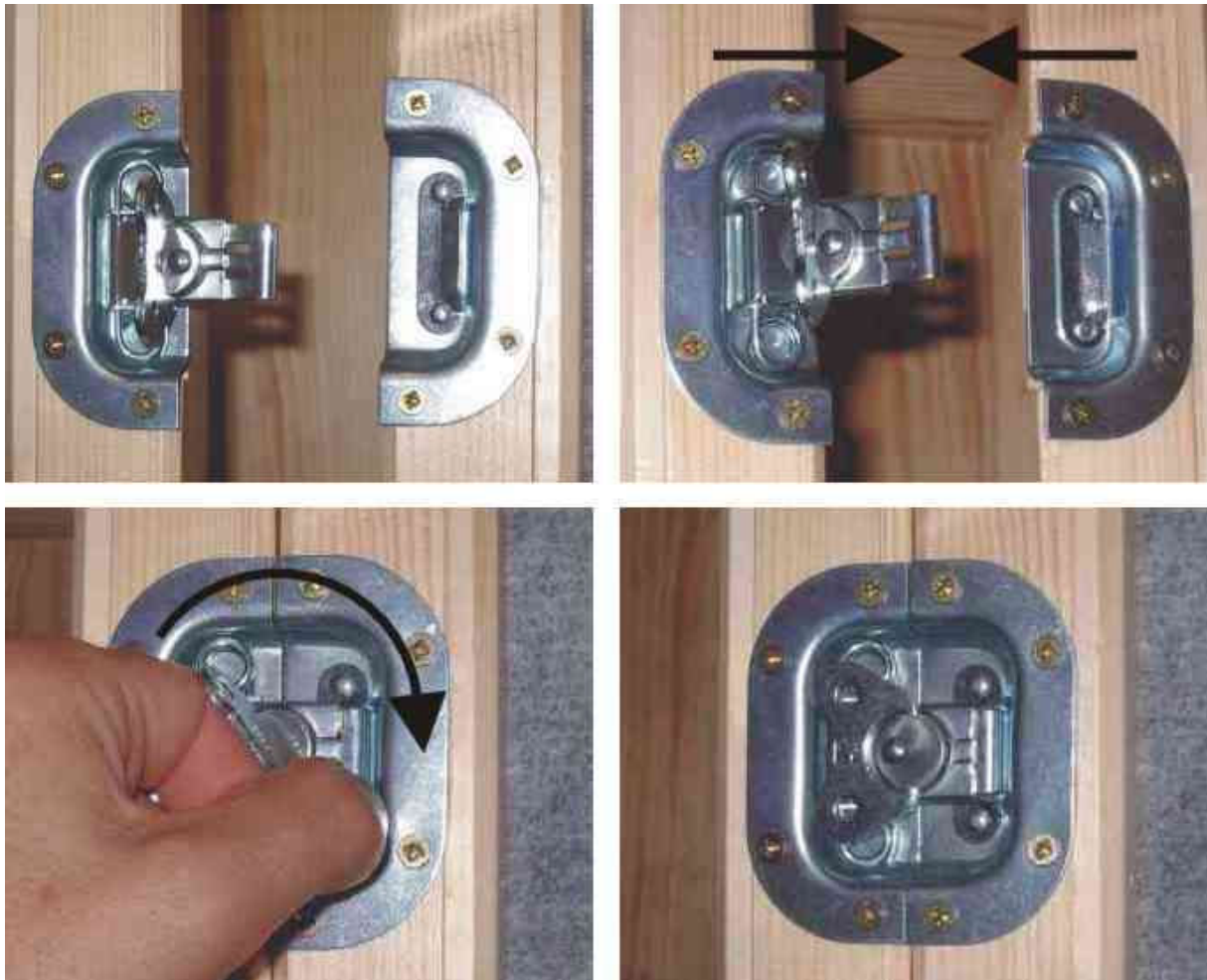

#### 4. Varieties

There are two types to be ordered depending on which side contains the door. Both types can be assembled to have side door or back door.

The side door is on the left side at type 'A' and on the right side at type 'B'

The following drawings show the location of the doors from above at both types.

##### MTC 160 A

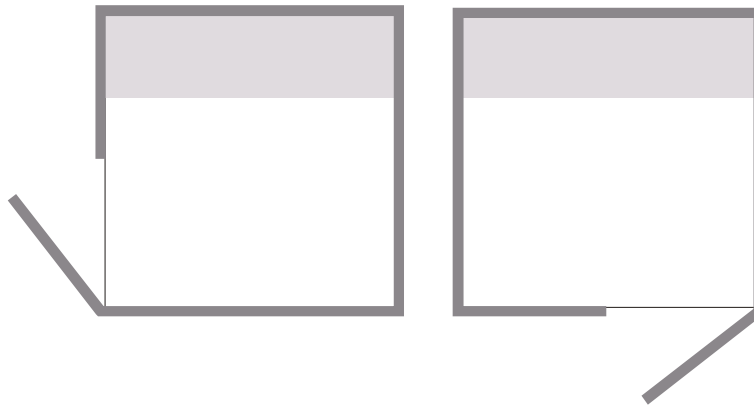

##### MTC 160 B

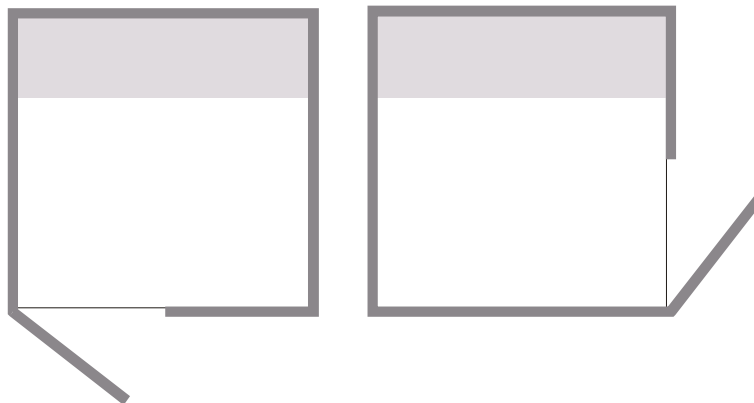

MTC 160 A is basically delivered. MTC 160 B could be required if the cabins have to be placed close to each other and only a side door installation is possible.

Consider the possibilities and limitations of the available place before ordering!

## **5. Colours and Pictures**

The interpreter cabin's basic colour is pine as in the pictures below. If different colour is required it can be changed for minimal extra charge. In this case it should be considered that the damages of the surface are more visible.



## **6. Materials and cleaning**

### **Windows:**

*Material:* translucent polystyrene.

*Cleaning:* use usual window-cleaner not containing any mordant or scratching component

### **Table-unit**

*Material:* shellacked pine panel with 2 mm thick ABS plastic based edge-sealing resisting stronger strains too.

*Cleaning:* use usual furniture-cleaner not containing any mordant or scratching component.

### **Wall-unit:**

*Material:* 5 mm thick laminated HDF panel.

*Cleaning:* use usual furniture-cleaner not containing any mordant or scratching component.

### **Inner covering:**

*Material:* usual heat and sound insulation broadloom carpet

*Cleaning:* use vacuum cleaner for usual dust, crumb...etc., cleaner machine for other contamination (eg. liquid, mud) and usual recommended cleaning supplies for carpets.

**Protect especially from oily and paint based impurities!**